

Agenda

WI Presidents Council

2014 Annual Meeting

Date: Friday, October 17th, 2014
Time: 9:00 a.m. to 12:00 noon
Where: Laguna Vista room (second floor) at the Chula Vista Resort, 2501 River Road, Wisconsin Dells, WI. The conference center is located at the North end of the facility.
Organizer: Jim Lacy, (608) 770-0617, lacy@wisc.edu

Expected Participants: Land Information Officers Network, State Agency Geospatial Information Committee, WI County Surveyors Association, WI Dept. of Transportation, WI DOA Intergovernmental Relations, WI Geographic Information Coordination Council, WI Land Information Association, WI Land Title Association, WI Real Property Listers, WI Register of Deeds, WI Society of Land Surveyors, WI State Cartographer's Office.

1. Introductions, agenda repair - *Jim Lacy*
2. Follow-up on 2013 meeting - *Jim Lacy*
3. Discussion items
 - a. Efforts to develop a statewide geospatial strategy - *Jon Schwichtenberg, WIGICC*
 - b. NextGen 911: Who is involved in your jurisdiction? - *Jim Lacy, SCO*
4. Organization updates - *All*
 - a. Each organization has approximately 5-7 minutes to informally report on major issues they expect to address in the upcoming year.
 - b. No PowerPoint please! We will not have a projector available.
 - c. Goal is to promote communication and collaboration between organizations.
 - d. We will break at approximately 10:30.
 - e. Batting order: SCO, DOA Intergov, WROD, WRPL, WLTA, LION, WLIA, WIGICC, WSLs, WCSA, SAGIC, DOT.
5. Wrap up and closing - *Jim Lacy*
 - a. Review any action items
 - b. 2015 meeting

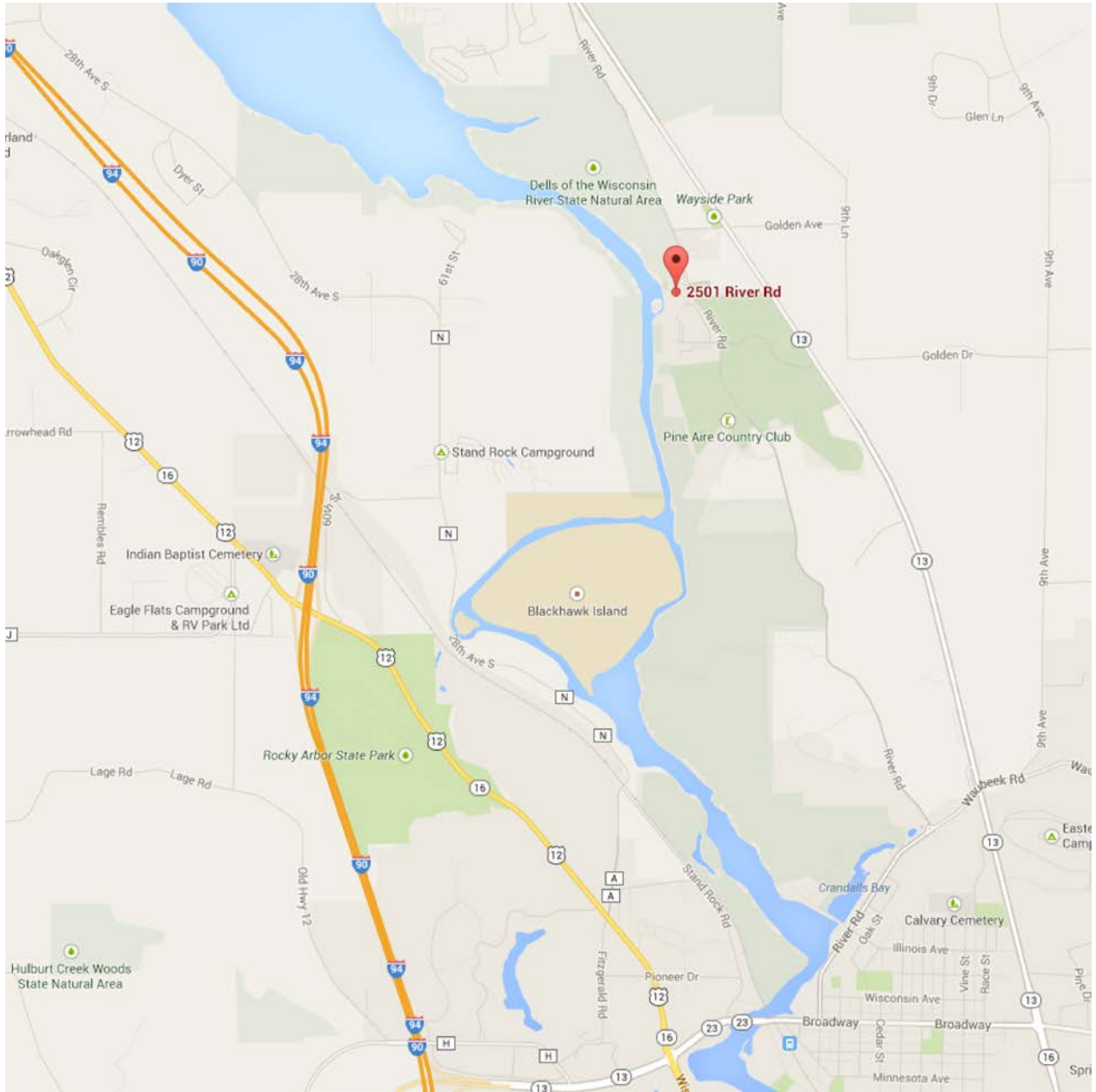

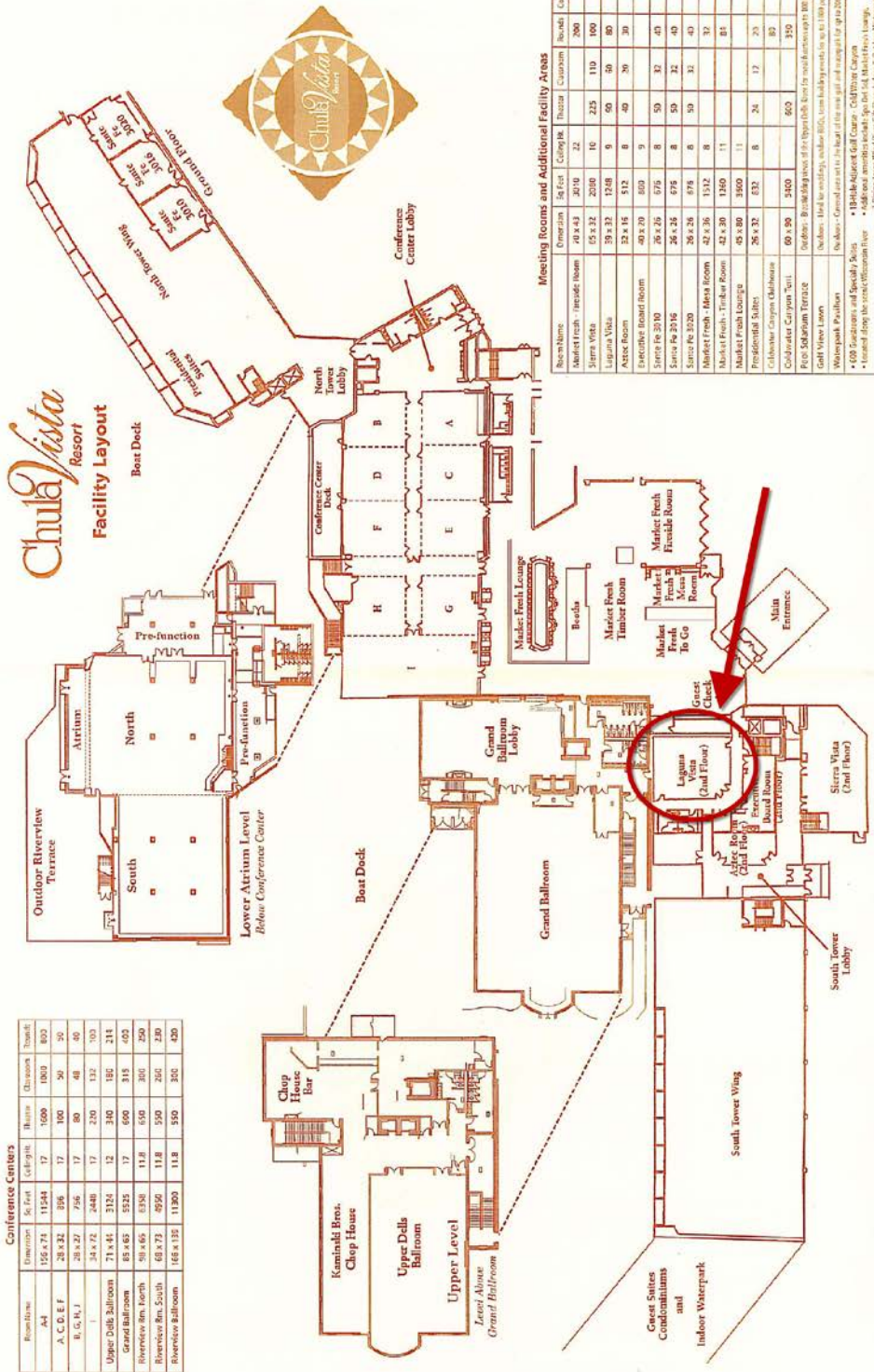

Conference Centers

Room/View	Dimensions	Sq. Feet	Capacity	Tables	Classrooms	Theater
A4	156 x 71	11084	17	1000	1000	800
A, C, D, E, F	28 x 22	616	17	100	50	30
B, G, H, J	28 x 27	756	17	80	48	30
	34 x 72	2448	17	200	132	100
Upper Deck Ballroom	71 x 41	2914	12	310	182	214
Grand Ballroom	85 x 65	5525	17	600	315	400
Riverview Atr. North	91 x 65	5918	11.8	518	265	250
Riverview Bn. South	61 x 73	4453	11.8	350	202	230
Riverview Ballroom	168 x 135	22680	11.8	350	302	420

Meeting Rooms and Additional Facility Areas

Room Name	Dimensions	Sq. Feet	Capacity	Theater	Classroom	Books	Conference
Market Fresh - Inside Room	40 x 43	1720	22	225	110	100	200
Stirna Vista	55 x 22	1210	16	60	50	50	80
Laguna Vista	39 x 32	1248	9	50	38	30	30
Atrium Room	32 x 16	512	8	30	20	20	20
Executive Board Room	40 x 20	800	5	50	37	40	40
Stirna PC 2010	29 x 26	754	8	30	22	40	40
Stirna PC 2016	26 x 24	624	6	30	22	40	40
Market Fresh - Meet Room	36 x 28	1008	6	30	32	32	32
Market Fresh - Trainer Room	42 x 36	1512	8	30	32	32	32
Market Fresh Lounge	45 x 30	1350	11				81
Presidential Suite	26 x 32	832	6	24	17	25	12
Collaboration Offices	60 x 90	5400					80
Collaboration Offices	60 x 90	5400					110
Office 5400sqm Terrace							110

* Maximum Capacity: 2000
 * Capacity for a 20' x 30' room
 * Capacity for a 20' x 40' room
 * Capacity for a 30' x 30' room
 * Capacity for a 30' x 40' room
 * Capacity for a 30' x 50' room
 * Capacity for a 40' x 30' room
 * Capacity for a 40' x 40' room
 * Capacity for a 40' x 50' room
 * Capacity for a 50' x 30' room
 * Capacity for a 50' x 40' room
 * Capacity for a 50' x 50' room
 * Capacity for a 60' x 30' room
 * Capacity for a 60' x 40' room
 * Capacity for a 60' x 50' room
 * Capacity for a 60' x 60' room
 * Capacity for a 70' x 30' room
 * Capacity for a 70' x 40' room
 * Capacity for a 70' x 50' room
 * Capacity for a 70' x 60' room
 * Capacity for a 70' x 70' room
 * Capacity for a 80' x 30' room
 * Capacity for a 80' x 40' room
 * Capacity for a 80' x 50' room
 * Capacity for a 80' x 60' room
 * Capacity for a 80' x 70' room
 * Capacity for a 80' x 80' room
 * Capacity for a 90' x 30' room
 * Capacity for a 90' x 40' room
 * Capacity for a 90' x 50' room
 * Capacity for a 90' x 60' room
 * Capacity for a 90' x 70' room
 * Capacity for a 90' x 80' room
 * Capacity for a 90' x 90' room
 * Capacity for a 100' x 30' room
 * Capacity for a 100' x 40' room
 * Capacity for a 100' x 50' room
 * Capacity for a 100' x 60' room
 * Capacity for a 100' x 70' room
 * Capacity for a 100' x 80' room
 * Capacity for a 100' x 90' room
 * Capacity for a 100' x 100' room